

**Stainless Steel Low Pressure Pipe Fittings -
EQUAL TEE
DATA SHEET
ZL-S8502 Series**



Description

Brought to you by ZL, a series of stainless steel threaded fittings, suitable for applications requiring a secure and reliable pipe connection. Heavily used within the plumbing industry, water and gas will flow through in a tightly sealed construction.

These T shape fittings are made from a durable 316 stainless steel to ensure a simple and secure connection for pipe and hose work. All models are highly reliable and excellent quality.

Available in a variety of sizes:

S8502-1/4"F*1/4"F*1/4"F-01
S8502-3/8"F*3/8"F*3/8"F-01
S8502-1/2"F*1/2"F*1/2"F-01
S8502-3/4"F*3/4"F*3/4"F-01
S8502-1"F*1"F*1"F-01
S8502-1 1/4"F*1 1/4"F*1 1/4"F-01
S8502-1 1/2"F*1 1/2"F*1 1/2"F-01
S8502-2"F*2"F*2"F-01

FEATURES

- ∞ 316 Stainless steel - superior corrosion resistance
- ∞ 150 lbs fitting
- ∞ 3 BSP female connections
- ∞ Various sizes available
- ∞ T shape for pipe network connection

General Specifications

Connection 1	1/4 in to 2 in G Female
Connection 2	1/4 in to 2 in G Female
Connection 3	1/4 in to 2 in G Female
Fitting Type	Tee
Fitting Direction	Tee
Connection Gender 1	Female
Connection Gender 2	Female
Connection Gender 3	Female
Thread Standard 1	G (Parallel)
Thread Standard 2	G (Parallel)
Thread Standard 3	G (Parallel)
Material	316 Stainless Steel
Application	Plumbing industry, water and gas

Dimensions

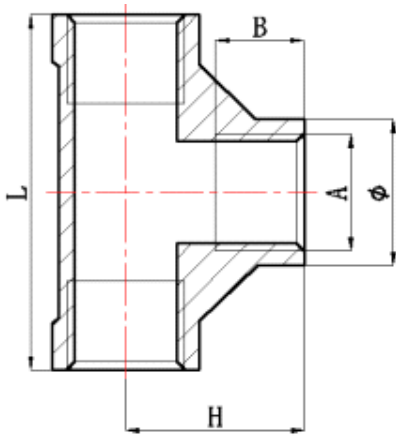

Code	A	B	H	L	Φ	Weight(g)
ZLS8502DN08	G1/4"	11	19	38	Φ18	41.5
ZLS8502DN10	G3/8"	11.5	23	46	Φ21.5	55.0
ZLS8502DN15	G1/2"	10.5	27	54	Φ26.5	86.0
ZLS8502DN20	G3/4"	11.5	32	64	Φ32	135.0
ZLS8502DN25	G1"	13	37	74	Φ39.5	203.0
ZLS8502DN32	G1 1/4"	15	43	86	Φ48.5	326.0
ZLS8502DN40	G1 1/2"	16	48	96	Φ55	425.0
ZLS8502DN50	G2"	18.5	56	112	Φ67	665.0