

Plastic Magnetic Dirt Separator

DATA SHEET

ZL-2566



Description

The plastic magnetic dirt separator is compact and easy to install to combat the problems caused by magnetic system sludge and non-ferrous debris.

Applicable medium: Water, glycol solutions Max. percentage of glycol is 30%
Maximum working temperature: 90°C
Maximum working pressure: 4bar
Connections: G3/4" (ISO228-1)、Φ22mm x Φ22mm x G3/4"

Product features

- Dual decontamination - removal of magnetite and non-ferrous metal fragments
- Wear-resistant 16 mesh stainless steel filter - helps to break down and retain all non-ferrous metal fragments before entering the boiler
- High Strength 5000GS magnet- Absorbs and retains all magnetic debris circulating in system to prevent damage to system components
- Large bore drain plug- Enables simple and fast drainage for easy maintenance
- Small size, small body and multiple installation options- Make it easy to install in boiler and space limited areas
- Brass ball valves and connections - high quality brass fittings

Characteristic Components

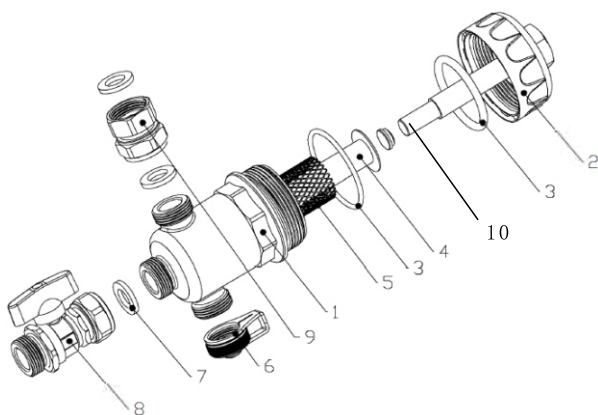

No.	Components	Materials
1	Valve body	Pa66
2	valve bonnet	Pa66
3	Seals	EPDM
4	Protective casing	PB
5	Filter net	Stainless steel
6	Plug cap	Brass
7	Gasket	EPDM
8	Ball valve	Brass
9	Connections	Brass
10	Magnet component	NdFeb

Dimensions

Code ZL2566343434 (Figure1~4)

Code ZL2566342222 (Figure 5)

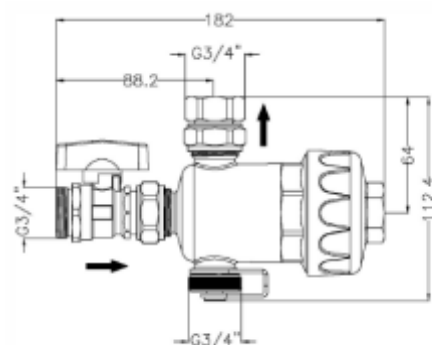

Figure 1

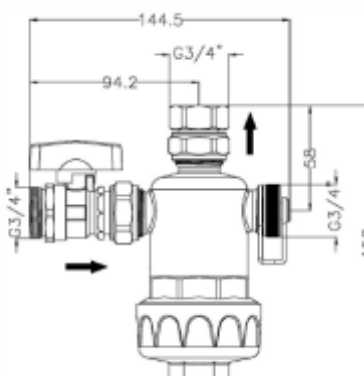

Figure 2

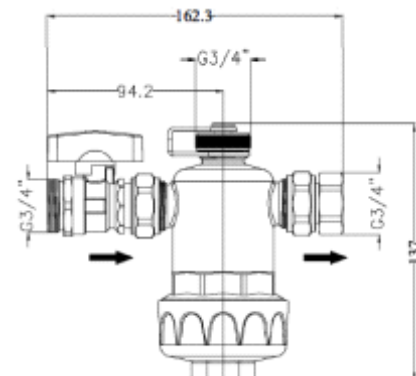

Figure 3

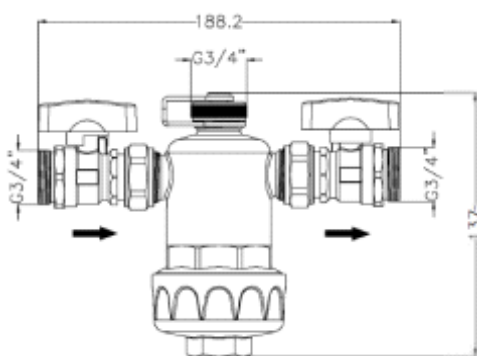

Figure 4

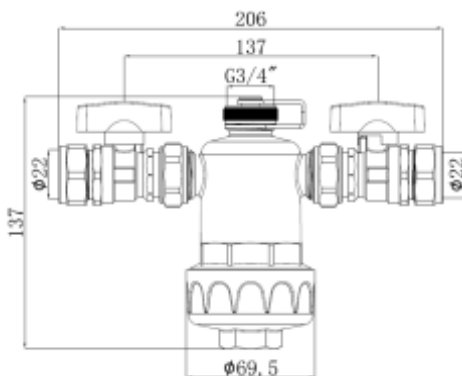

Figure 5

Hydraulic Characteristics

